

MODEL NUMBER	CAPACITY LBS [KG]	CABLE LENGTH FT [M]	MOUNTING BOLT AND GRADE	THREAD TORQUE FT-LBS [Nm]
HISP4-22LB	22 LB [10KG]	10FT [3M]	M6 X 1.0; GRADE 8.8 M6 X 0.5; GRADE 8.8	7 [10]
HISP4-44LB	44 LB [20KG]			
HISP4-110LB	110 LB [50KG]			
HISP4-220LB	220 LB [100KG]			

REV.	ECO/DDC	DESCRIPTION	DATE	DRAFT	CHECK	APV'D
A	----	RELEASED.	06-20-23	V.J.C.	J.M.	V.J.C.

DIMENSIONS- INCHES & [mm]

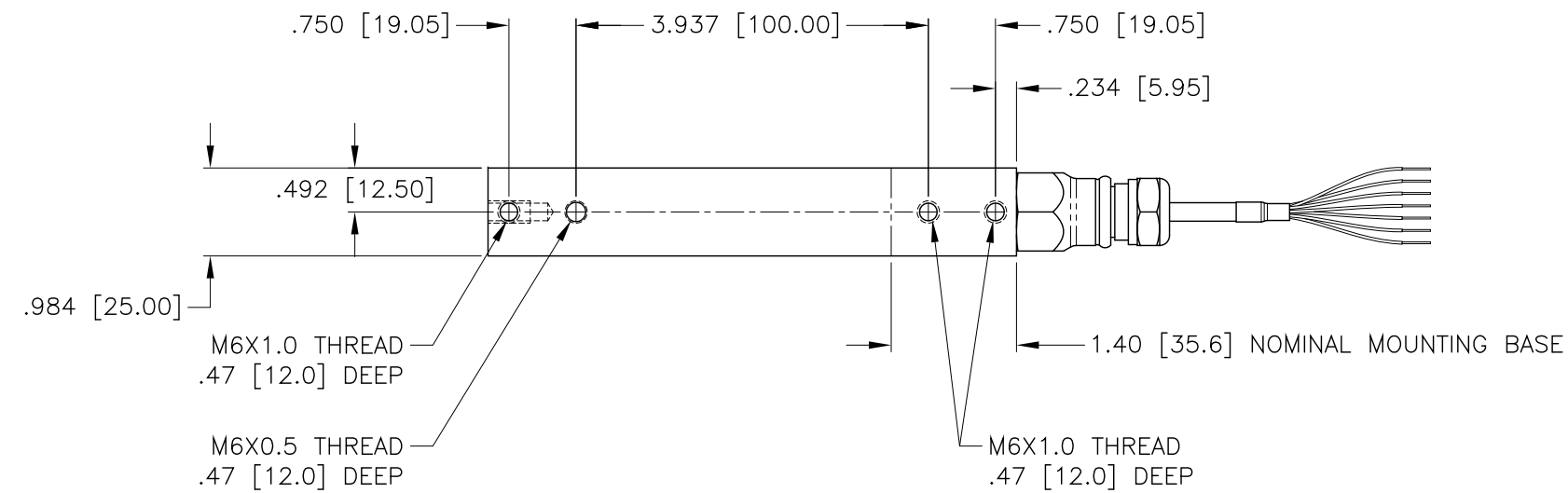
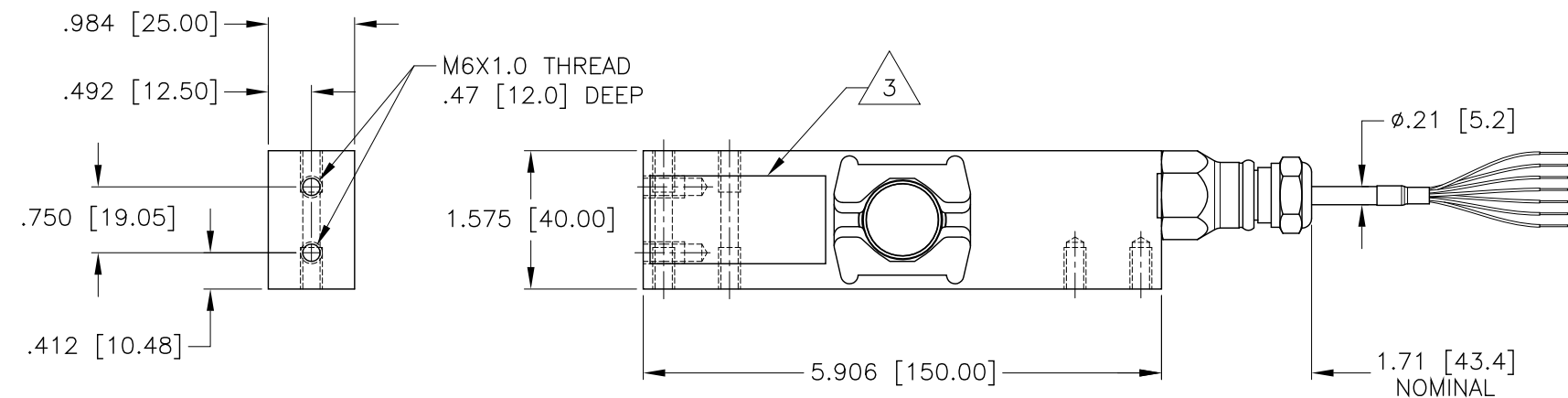
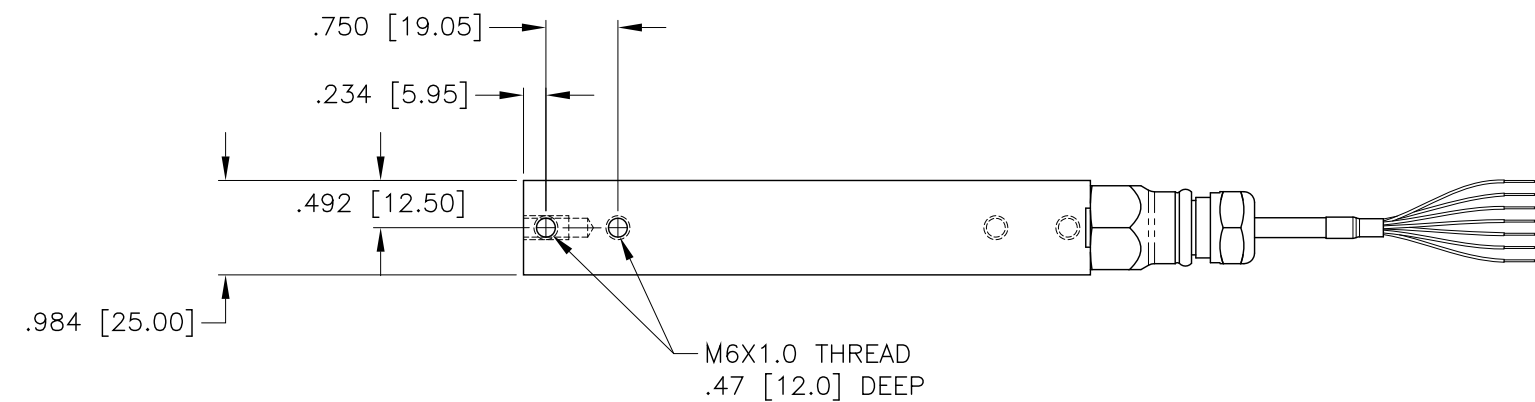

10. SEE SHEET 2 FOR FULL SCALE 2 DIMENSIONAL DROP-IN CAD FILE VIEWS.
9. LOAD SENSOR COMPENSATED TEMPERATURE RATING IS -10°C TO +40°C.
8. LOAD CELL SAFE OPERATING TEMPERATURE RATING IS -40°C TO +80°C. USAGE OF LOAD CELL AT TEMPERATURES BELOW -40°C REQUIRES THAT THE LOAD CELL AND CABLE BE TEMPERATURE CONTROLLED.
7. LOAD SENSOR BODY IS STAINLESS STEEL 17-4PH (1.4548).
6. CABLE IS SHIELDED, 6 CONDUCTOR. CABLE SHIELD IS FLOATING FROM LOAD SENSOR BODY. SEE TABLE FOR CABLE LENGTHS.
5. LOAD SENSOR WIRE COLOR CODE:

EXCITATION +	RED
EXCITATION -	BLACK
SIGNAL +	GREEN
SIGNAL -	WHITE
C2 +	GRAY
C2 -	VIOLET
SHIELD	YELLOW

4. CABLE WIRE ENDS ARE STRIPPED BACK AND TINNED.

3 LOCATION OF MODEL/SERIAL NUMBER LABEL.

2. THIS DRAWING IS SUBJECT TO CHANGE WITHOUT NOTICE.

1. RATED OUTPUT: 2mV/V ±0.2mV/V.

NOTES: UNLESS OTHERWISE SPECIFIED

PROPRIETARY NOTICE
ALL DATA AND INFORMATION CONTAINED IN OR DISCLOSED BY THIS DOCUMENT IS CONFIDENTIAL AND PROPRIETARY INFORMATION OF HARDY PROCESS SOLUTIONS INC. AND ALL RIGHTS THEREIN ARE EXPRESSLY RESERVED. BY ACCEPTING THIS MATERIAL THE RECIPIENT AGREES THAT THIS MATERIAL AND THE INFORMATION CONTAINED THEREIN IS HELD IN CONFIDENCE AND IN TRUST AND SHALL NOT BE USED, COPIED, REPRODUCED IN WHOLE OR IN PART, NOR ITS CONTENTS REVEALED IN ANY MANNER TO OTHERS, EXCEPT TO MEET THE SPECIFIC PURPOSE FOR WHICH IT WAS DELIVERED.

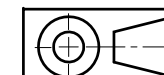

ITEM	QTY	PART NUMBER	DESCRIPTION	COMMENTS
PARTS LIST				
UNLESS OTHERWISE SPECIFIED DIMENSIONS ARE IN INCHES [MM]		CONTRACT NO.		
TOLERANCES ARE: DECIMALS: .XX = ±.03 [.8] .XXX = ±.010 [.25]		APPROVALS		
ANGLES: ±0°, 30°		DRAWN V. CHULA DATE 06-20-23		
MATERIAL		CHECKED J. MOEN DATE 06-20-23		
FINISH		APPROVED V. CHULA DATE 06-20-23		
DO NOT SCALE DRAWING		ISSUED V. CHULA DATE 06-20-23		
		PRODUCTION DATE		
TITLE OUTLINE DRAWING, LOAD SENSOR, HISP4 SERIES		SIZE	FSCM	DRAWING NO.
		D	21316	0588-0213
FILE NAME: 588213A1.DWG		SCALE: NONE	SHEET 1 OF 2	



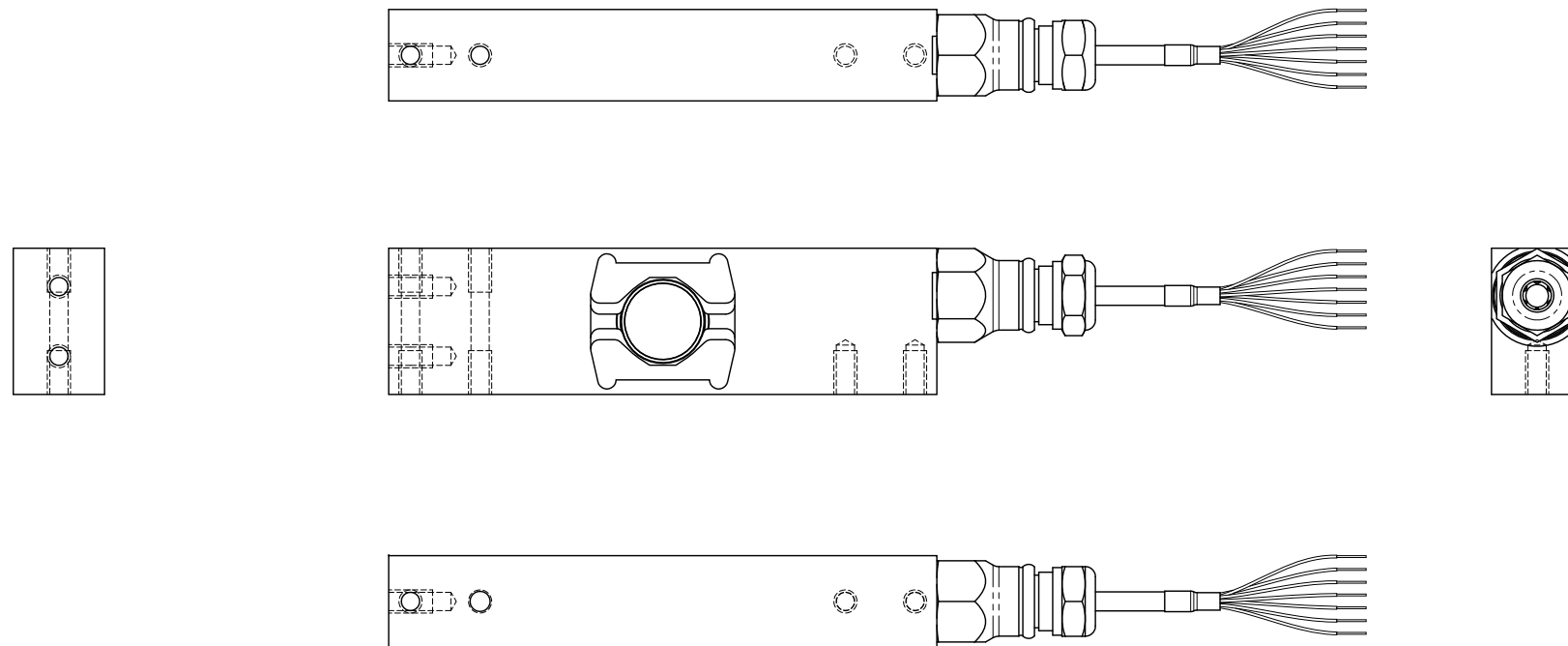

DROP-IN CAD FILE VIEWS

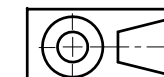

HARDY PROCESS SOLUTIONS			
TITLE OUTLINE DRAWING, LOAD SENSOR, HISP4 SERIES			
SIZE	FSCM	DRAWING NO.	REV.
D	21316	0588-0213	A
FILE NAME: 588213A1.DWG		SCALE: NONE	SHEET 2 OF 2